



Hanse 

540e

**2007 | [Grace]
Barcelona, ES**

3 cabins | 3 heads

110 HP Volvo

Electric winches
Plotter Raymarine hibridtouch
Electrical toilets
Bimini
Dinghy
Spanish flag

230.000 €

Taxes included
Impuestos incluidos

| TECHNICAL SPECIFICATIONS |

LOA: 16,08 m
DRAFT: 2,43 m
BEAM: 2,43 m

| BASIC EQUIPMENT |

- 3 double cabins, each with its own bathroom, have just been renovated with all the upholstery and brand new mattresses.
- + cabin with crew bathroom in the bow.

| ENGINES |

- 110 HP Volvo
- Engine hours: 4000 h

| ESPECIFICACIONES TÉCNICAS |

ESLORA: 16,08 m
CALADO: 2,43 m
MANGA: 2,43 m

| EQUIPAMIENTO BASE |

- 3 camarotes dobles, cada uno con su baño, acaban de ser renovados con toda la tapicería y colchones a estrenar.
- + camarote con baño de marinería en la proa.

| MOTORES |

- 110 HP Volvo
- Horas de motor: 4000 h

| EQUIPMENT |

- Navigation zone 1
- Electrical winches
- Full electronic
- Main sail 85m² & genoa 69m²
- Code 0 sail with curler
- Outrigger
- Lazy bag with cover natural
- GORI 3-Blades folding propellers

| SAFETY |

- Full safety equipment
- Life raft 12 pax
- EPIRB
- AIS

| EQUIPAMIENTO |

- NAVEGACIÓN ZONA 1
- Winches eléctricos
- Electrónica completa
- Velas: mayor 85m² y génova 69m²
- Vela código cero con enrollador
- Tangón
- Lazy bag con funda
- Hélice tri-pala plegable GORI

| SEGURIDAD |

- Equipamiento de seguridad completo
- Balsa salvavidas 12 pax
- EPIRB
- AIS

| COMFORT |

- Bimini on helm station
- Aft cockpit cushions
- 200 kg davits
- Bow thruster
- Inverter 24/220V
- Watermaker 120L 24-220V
- TECMA electrical toilets
- Additional freezer 120L
- Microwave oven 220V
- Dishwasher 6 sets 220V
- WIFI
- TV

| ELECTRONICS |

- Raymarine hybrid touch plotter
- ICOM VHF with DSC, IC-M423G-GPS-
- Raymarine Autopilot
- 4 Raymarine watches | 2 on starboard. 1 tridata and 1 wind ST60+ Ditto on port side
- Outdoor music system Fusion MS-RA55+ 4 outdoor speakers

| COMFORT |

- Bimini en timonera
- Cojines en bañera
- Pescantes de 200 kg
- Hélice de proa
- Inversor 24/220V
- Potabilizadora 120L/h 24-220V
- Lavabos eléctricos TECMA
- Nevera adicional de 120L
- Horno microondas 220V
- Lavavajillas de 6 cubiertos 220V
- WIFI
- TV

| ELECTRÓNICA |

- Plotter Raymarine hibrid touch
- VHF ICOM con DSC, IC-M423G-GPS-
- Piloto Automático Raymarine
- 4 relojes Raymarine | 2 en estribor. 1 tridata y 1 wind ST60+ Idem en lado babor
- Equipo música exterior Fusión MS-RA55+ 4 bafles exteriores

| ELECTRONICS |

- Furuno VHF with DSC, FM8800D
- BLU Sailor with DSC, HC4500B
- Navtex CCI, NCR-333
- Raymarine multicolour watch ST60
- Autopilot interior repeater
- "Smartcontroller" Radar transponder (SART), Sevenstar Electronics S.701

| EXTRAS |

- DINGHY
- SUZUKI 30cv engine
- SUZUMAR boat 4 meters
- Suitable for water skiing

| ELECTRÓNICA |

- VHF Furuno con DSC, FM8800D
- BLU Sailor con DSC, HC4500B
- Navtex JRC, NCR-333
- Reloj Raymarine multi ST60
- Repetidor interior de Piloto Automatico
- "Smartcontroller" Transpondedor radar (SART), Sevenstar Electronics S.701

| EXTRAS |

- DINGHY
- Motor SUZUKI 30cv
- Lancha SUZUMAR 4 metros
- Apta para esquí náutico



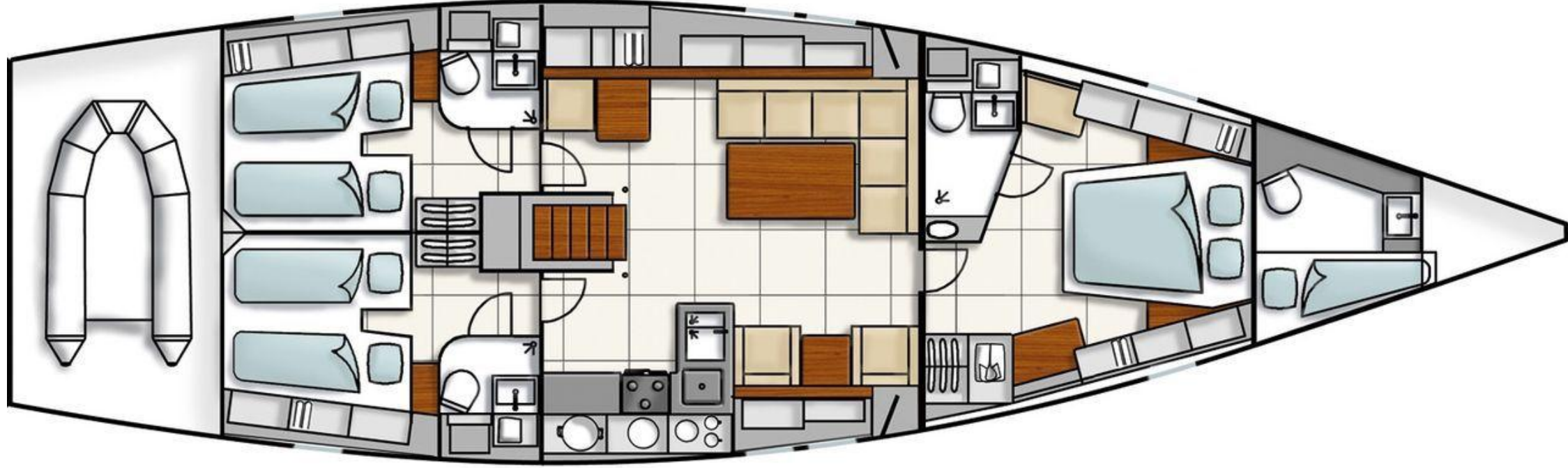



estupenda
náutica

Expertos en Catamarans
estuopendanautica.com























estupenda
náutica



Expertos en Catamarans
estuopendanautica.com















estupenda
náutica

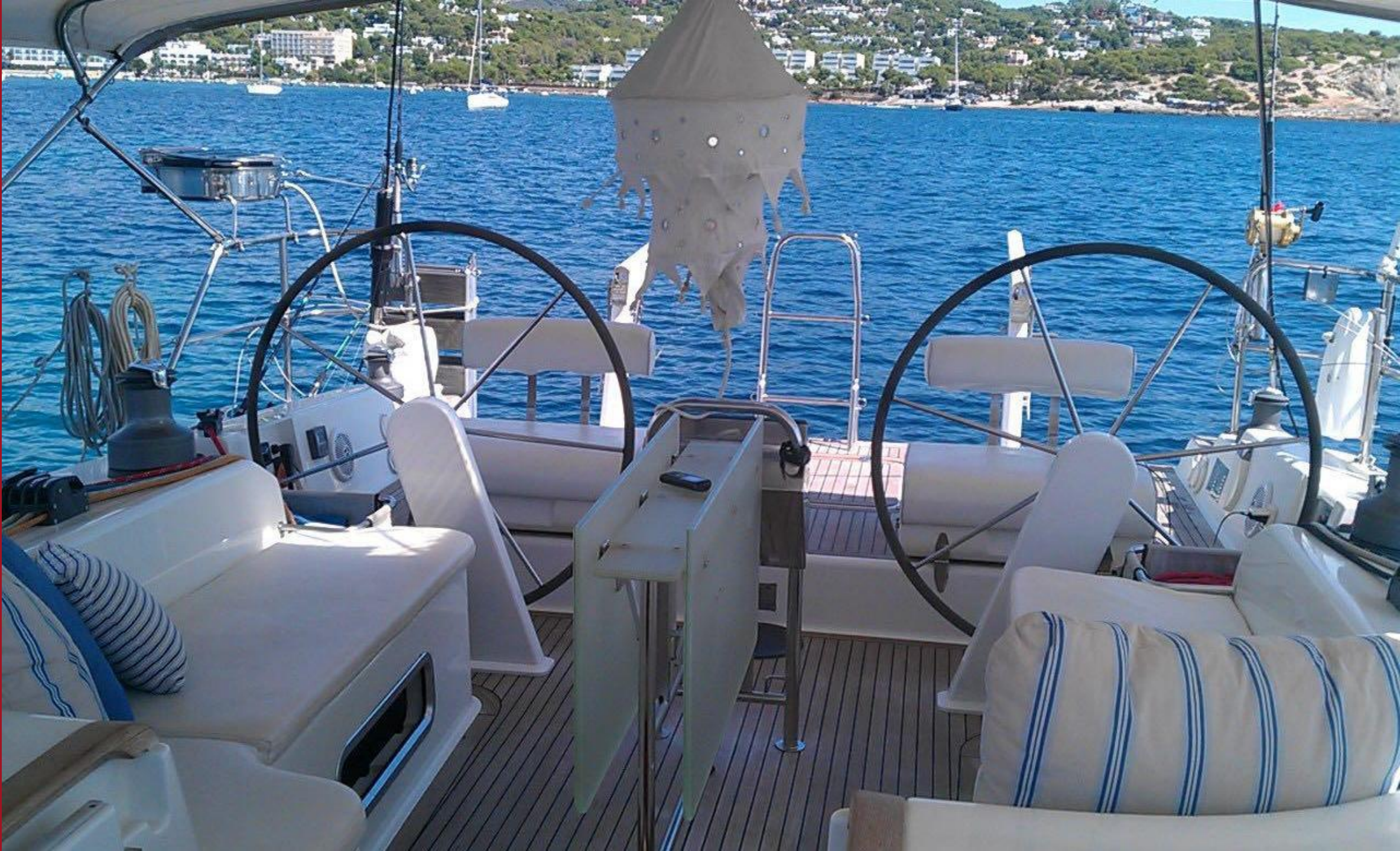

Expertos en Catamarans
estuopendanautica.com





estupenda
náutica

TALK TO US OR VISITE OUR WEBSITE
LLÁMANOS O VISITA NUESTRA WEB

[estupendanautica.com](https://www.estupendanautica.com)

T: +34 931 145 547
