



58

6 Cabins | 2018

Seychelles Between

2 x 75 HP Yanmar
Aft bathing platform
Solar Panels
Central Airconditioning
Electrical toilets
Generator Northern
Full hotel equipment
Active chartering business

1.620.000€

Taxes NOT included
Impuestos NO incluidos





| TECHNICAL SPECIFICATIONS |

LOA: 17.56 m | 57'7" ft

BEAM: 8.45 m | 27'9" ft

DRAFT: 1.83m | 6' ft

| BASIC EQUIPMENT |

- 6 cabins | 5 heads
- Additional forpic (port side) crew cabin fully equipped, with air conditioning
- Electrical Jabsco toilets

| ENGINES |

- 2 x 110 HP Yanmar | V-drive
- Engine hours: starboard 4237 (2018), portside 3013 hours (replaced at 2021)
- Fuel capacity: 900 l

| ESPECIFICACIONES TÉCNICAS |

ESLORA: 17.56 m | 57'7" pies

MANGA: 8.45 m | 27'9" pies

CALADO: 1.83m | 6' pies

| EQUIPAMIENTO BÁSICO |

- 6 cabinas | 5 baños
- Cabina de tripulación adicional en forpic (babor) totalmente equipada, con AA
- Baños eléctricos Jabsco

| MOTORES |

- 2 x 110 HP Yanmar | V-drive
- Horas de motor: estribor 4237hs (2018), babor 3013 hs (reemplazado en 2021)
- Capacidad de combustible: 900 l



| AMENITIES |

- Central airconditioning system for 6 cabins and saloon (Webasto 72.000 BTU)
- Fully equipped kitchen (dishwasher, microwave; in general full equipment for chartering business)
- Washer dryer in stbd side hull corridor
- Extra fridges: in port side hull corridor; in aft cockpit , in flybridge bar
- Flybridge corian bar with sink (warm and cold water)
- Grill (electrical or charcoal) on the flybridge bar
- Sprayhood around flydeck
- Aft cockpit shower with warm & cold water
- Aft cockpit – extra side and aft curtains

| AMENITIES |

- Sistema de aire acondicionado central para 6 cabinas y salón (Webasto 72.000 BTU)
- Cocina totalmente equipada (lavavajillas, microondas; equipamiento completo para chartering)
- Lavadora/secadora
- Frigoríficos adicionales (pasillo del casco de babor, cabina de popa, barra de flybridge)
- Barra de corian flybridge con fregadero (agua fría y caliente)
- Parrilla en la barra del flybridge
- Capucha alrededor del flydeck
- Ducha en popa con agua fría y caliente
- Cabina de popa: cortinas laterales y de popa adicionales



| AMENITIES |

- Aft cockpit – diving cylinders stands (for 8 cylinders)
- Extra electrical sockets in toilets
- Aft bathing platform (electrical lifted)
- Whole deck and toilets floors covered with flexiteak
- Carpet flooring (saloon, kitchen & all cabins)
- Desalinator ECHOTec (210 l/h)
- Desalinator ECHOTec (110 l/h)

| HI-FI & ELECTRONICS |

- Flat TV 46 inch
- Bose sound system in saloon

| AMENITIES |

- Cabina de popa: 8 soportes para cilindros de buceo
- Tomas de corriente adicionales en los baños
- Plataforma eléctrica de baño en popa
- Pisos completos de cubierta y baños revestidos con flexiteak
- Pisos de alfombra (salón, cocina y todas las cabañas)
- Potabilizadora ECHOTec (210 l/h)
- Potabilizadora ECHOTec (110 l/h)

| HI-FI & ELECTRONICA |

- Televisor plano 46 pulgadas
- Sistema de sonido Bose en salón



| NAV EQUIPMENT |

- Bow thruster
- Raymarine navigation with Raymarine HD radar, Glass bridge, AIS 650
- Fishfinder (echo sounder)
- 3 electrical capstans
- Code D extra sail (soft forestay, manual roller)

| ELECTRICAL EQUIPMENT |

- 8 solar panels on the flydeck top
- Generator Northern Lights 20kW (4633 hs) portside (additional fuel transfer switch for fuel transfer from stbd side to portside)
- Generator Northern Lights 6kW (1118 hs) stbd side

| EQUIPAMIENTO DE NAVEGACIÓN |

- Hélice de proa
- Navegación Raymarine con radar Raymarine HD, Puente de cristal, AIS 650
- Sonda (ecosonda)
- 3 cabrestantes eléctricos
- Vela extra Código D (forestay blando, enrollador manual)

| EQUIPAMIENTO ELÉCTRICO |

- 8 paneles solares en el flydeck
- Generador Northern Lights 20kW (4633 hs) de babor (interruptor de transferencia de combustible adicional para la transferencia del lado STBD a babor)
- Generador Northern Lights 6kW (1118 hs)



| OTHER ACCESSORIES |

- Satellite phone (Iridium 9575)
- Full hotel equipment: premium quality for VIP charters 36 people, 3 full sets: bathrobes, swimming towels, bath towels, bed linen
Standard quality 24 people, 2 full sets: grey bath towels and grey bed linen standard and extra cushions
- Funair slide (9 meters, from flydeck directly to ocean)
- 2 seabob F5 SR + fast charger and dedicated storage bags
- 2 professional fishing rods (Big Game)
- 2 sea kayak
- ABC sets (for snorkeling)
- Comfort seats (10+)

| OTROS ACCESORIOS |

- Teléfono satelital (Iridium 9575)
- Equipamiento completo de hotel: calidad premium 36 personas, 3 juegos completos: albornoces, toallas para piscina, de baño, ropa de cama calidad estándar 24 personas, 2 juegos completos: toallas de baño grises y ropa de cama gris estándar y cojines extra
- Tobogán Funair (9 metros, desde el flydeck directamente al océano)
- 2 seabob F5 SR + cargador rápido y bolsas de almacenamiento dedicadas
- 2 cañas de pescar profesionales (Big Game)
- 2 kayaks de mar
- Conjuntos ABC (para hacer snorkel)
- Asientos confort (10+)



Chasing your Dreams
catamaransbcn.com





Chasing your Dreams
catamaransbcn.com





Chasing your Dreams
catamaransbcn.com





Chasing your Dreams
catamaransbcn.com









Chasing your Dreams
catamaransbcn.com





LEOPARD
CATAMARANS













Chasing your Dreams
catamaransbcn.com





Chasing your Dreams
catamaransbcn.com







Chasing your Dreams
catamaransbcn.com





Chasing your Dreams
catamaransbcn.com





Chasing your Dreams
catamaransbcn.com





Chasing your Dreams
catamaransbcn.com

















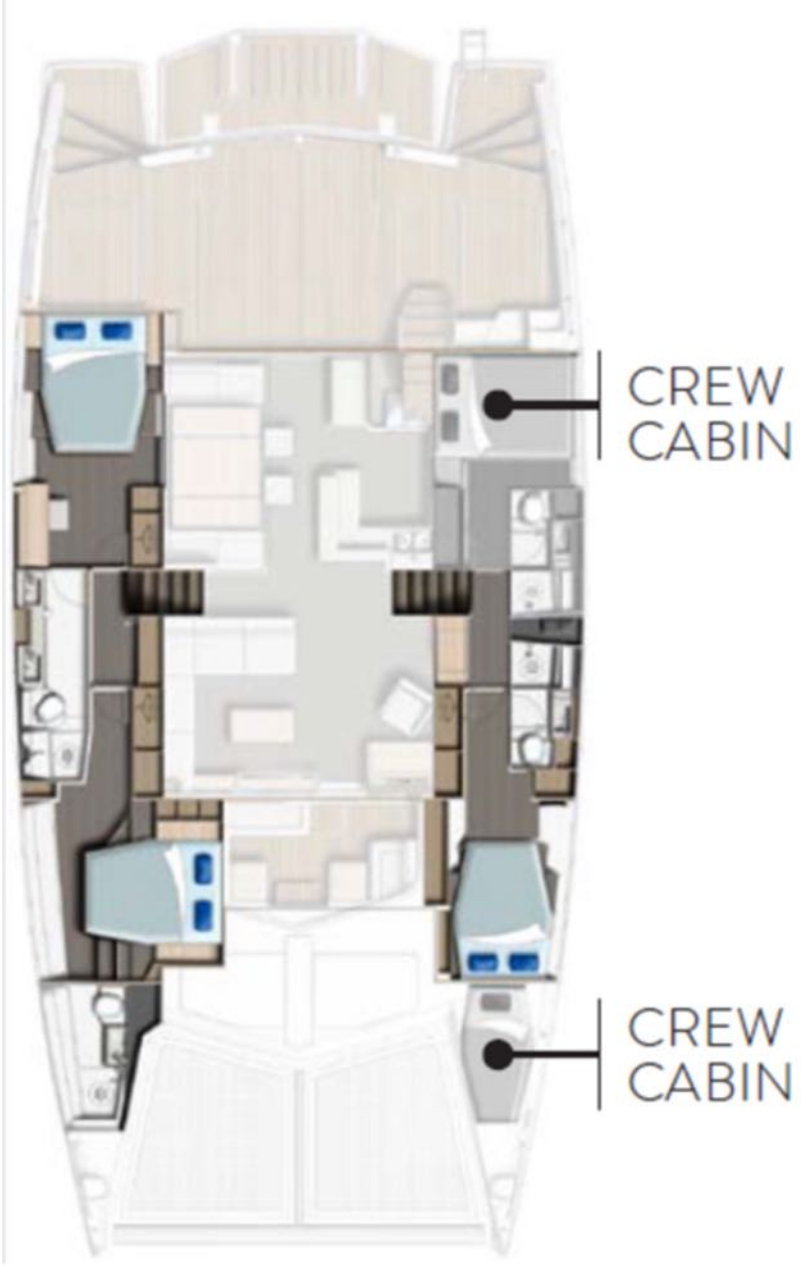
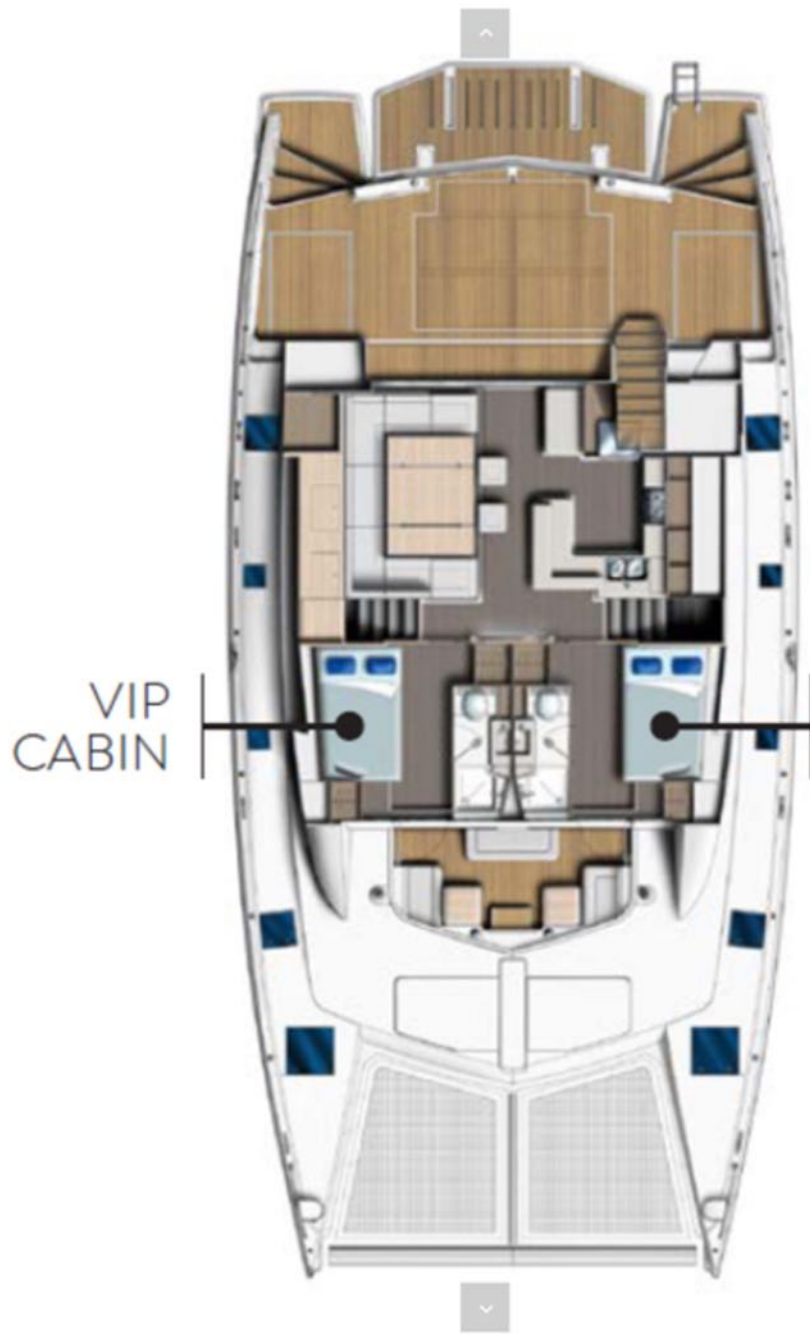























Chasing your Dreams
catamaransbcn.com





Chasing your Dreams
catamaransbcn.com





Chasing Your Dreams

marketing@catamaransbcn.com
catamaransbcn.com

**This picture is for reference*